

**più valore  
al nostro territorio**



**più valore  
al nostro territorio**



## Organization

Organizing Committee World MTB-O Championships 2011

IOF - International Orienteering Federation [www.orienteering.org](http://www.orienteering.org)

FISO Federazione Italiana Sport Orientamento [www.fiso.it](http://www.fiso.it)

ASD SPHERA in cooperation with ASD EREBUS VICENZA, ASD VIORETEAM, ASD BARBARANO, ASD MISQUILENSES

IOF Event Advisor: Antje Bornhak (Germany)

National Controller: Maurizio Ongania

Chairman of Organising Committee: Daniele Rago

Vice Chairman: Mauro Gazzerro

Event Director Gabriele Viale - via Cori 3, 36045 Alonte (Vi)

Cell. +39 338 61 39 508 – fax: + 39 0444 1770221; e-mail: [director@mtbo2011.org](mailto:director@mtbo2011.org)

Event Secretary: Giulia Zenere / Cecilia Colonna; tel +39 3466467774 e-mail: [staff@mtbo2011.org](mailto:staff@mtbo2011.org)

Race Director: Paolo Di Bert

Course Setters' Coordinator: Giuseppe Simoni

Controller: Roberto Manea

Maps: Angelo Frighetto

## Information

ASD SPHERA

Via L. Ariosto, 3 - 35010 Cadoneghe (PD) ITALIA

tel. 049706232 - fax 0498887479

E-mail: [segreteria@mtbo2011.org](mailto:segreteria@mtbo2011.org)

Web site: <http://www.mtbo2011.org>



Comitato Organizzatore MTBO 2011 - A.S.D. "SPHERA"  
Via L. Ariosto, 3 - 35010 Cadoneghe (PD)  
CF 92152920283 P. Iva 03946570284

event director: Gabriele Viale - cell. +39 338 6138508  
email: [director@mtbo2011.org](mailto:director@mtbo2011.org)

segreteria: tel. +39 049 706232 - fax +39 049 8887479  
cell. +39 346 6467774  
email: [segreteria@mtbo2011.org](mailto:segreteria@mtbo2011.org)

[www.mtbo2011.org](http://www.mtbo2011.org)



**più valore  
al nostro territorio**

## Classes

- WMTBOC W 21, M 21
- JWMTBOC W -20, M -20

### Participation restrictions.

Each Federation may enter a team of up to 16 competitors – up to 8 women and 8 men - in WMTBOC, and a team of up to 12 competitors – up to 6 women and 6 men - in JWMTBOC.

The maximum number of officials per team is 6.

In each competition a federation may enter:

- Individual events: max. 6 men, 6 women / federation /competition
- Relay events max. 2 male teams, 2 female teams / federation/ competition
- Sprint events max.6 men, 6 women / federation

Open Events (punch and go):

- MTB-Open Competitions

Open 1 (easy) , Open 2 (medium difficulty), Open 3 (difficult)

Open event: deadline for entries 19 August







**più valore  
al nostro territorio**

GROUND FLOOR

LOCATION OF:

ENTRANCE – HOTEL FRONT DESK – EVENT DESK – BREAKFAST ROOM N1 AND N2

**HOTEL  
CASTELLI**

**HOTEL CASTELLI**

**GROUND FLOOR**

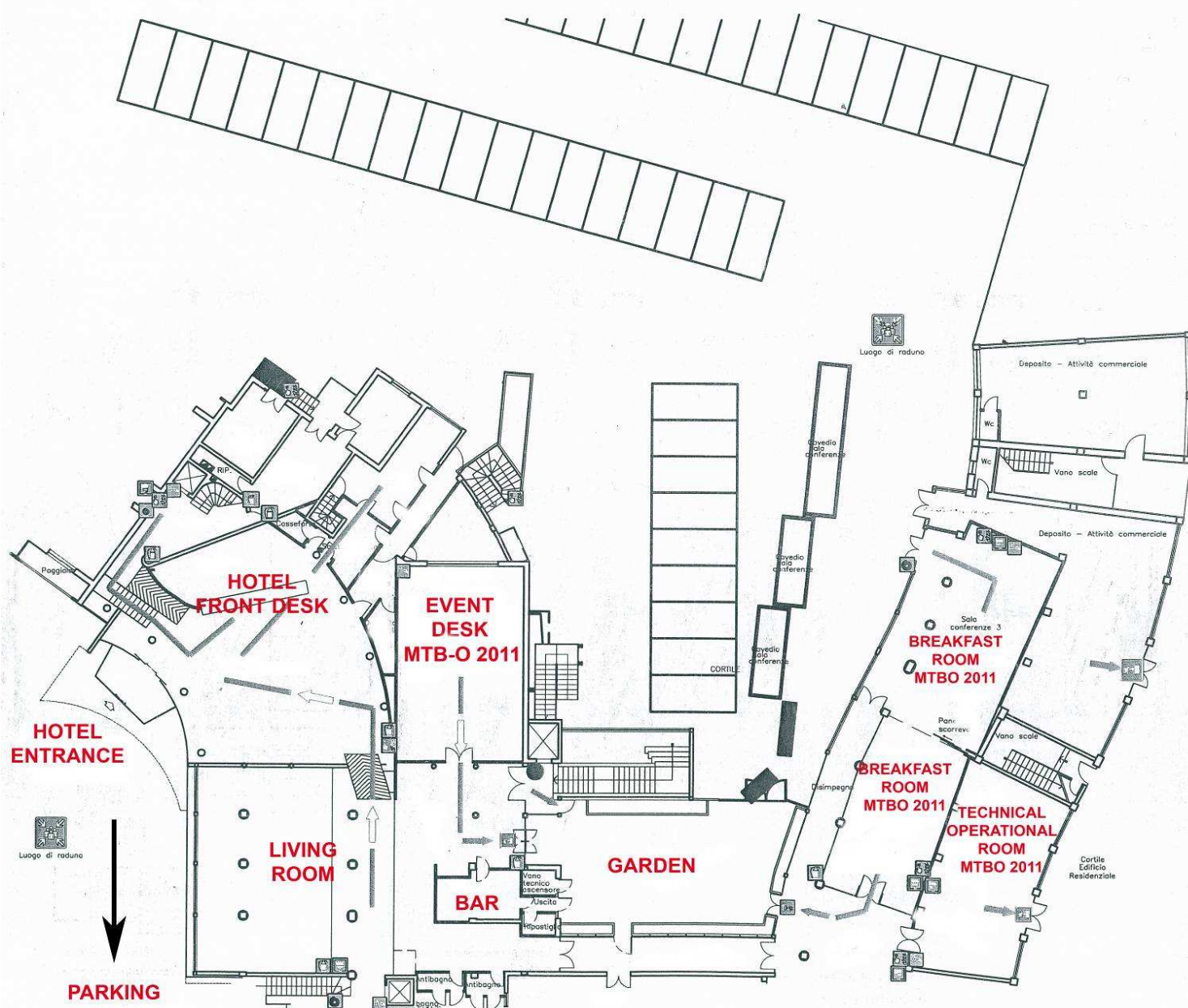





**più valore  
al nostro territorio**

**BASEMENT  
PRESS ROOM – TEAM LEADERS MEETING ROOM**

**HOTEL  
CASTELLI**

**HOTEL CASTELLI**

**BASEMENT**

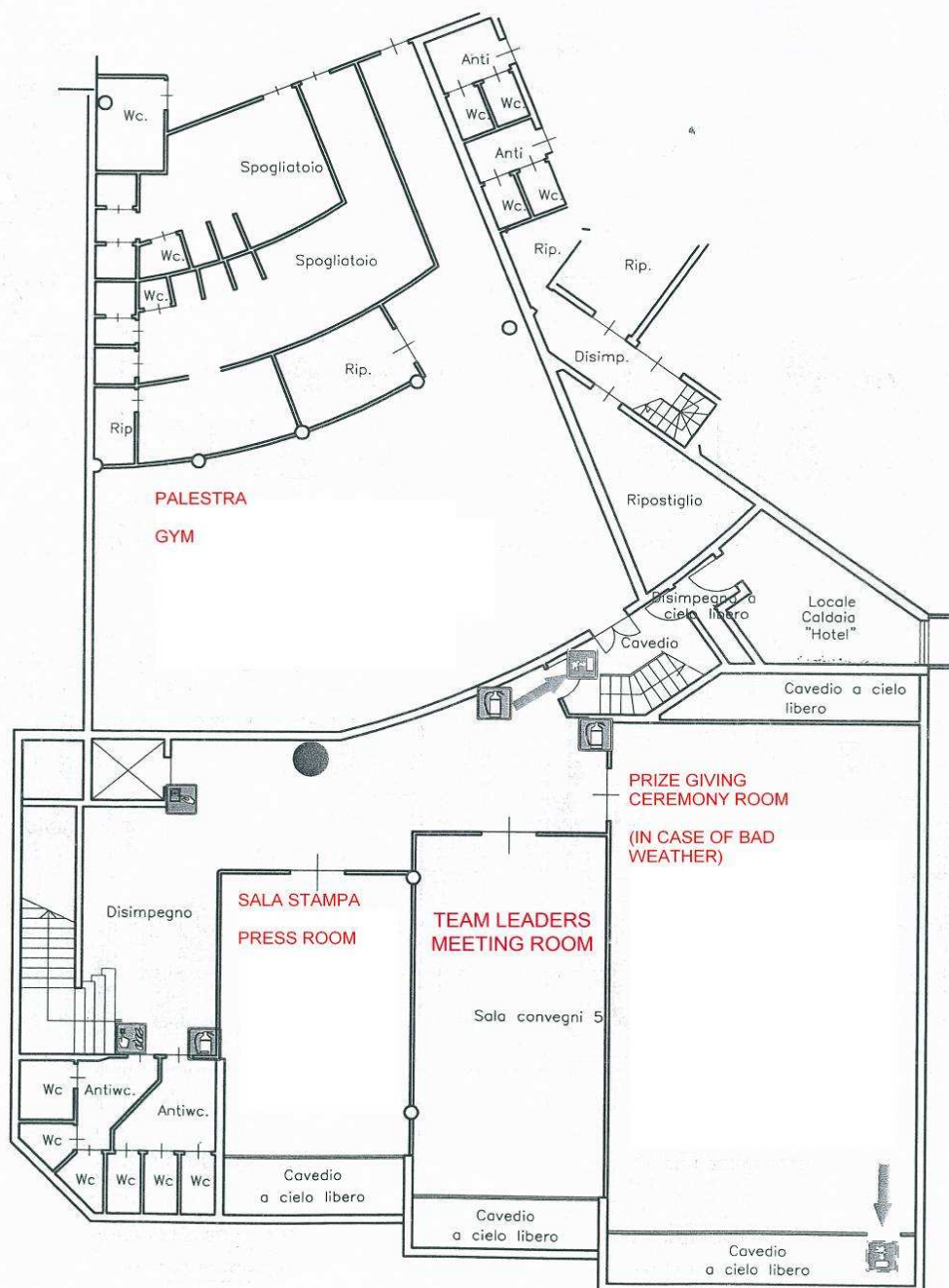



**più valore  
al nostro territorio**

## Detailed Programme

### 20th August, Saturday

10:00 – 13:00 / 15:00 – 22:00 Opening hours of the Event Office – Hotel Castelli, Montecchio Maggiore:  
accreditation and accommodation

12:30 – 14:30 Lunch (\*\*)

15:00 – 18:30 Training opportunity Brendola  
(10 minutes by car from the event center)

19:00 – 21:00 Dinner (\*\*)

### 21th August, Sunday

07:30 – 08:30 Breakfast (\*)

09:00 – 13:00 / 15:00 – 22:00 Opening hours of the Event Office – Hotel Castelli, Montecchio Maggiore

12:30 – 14:30 Lunch (\*\*)

15:00 – 18:00 Model Event – Nanto - Castegnaro  
(35 minutes by car from the event center)

19:00 – 19:45 Team Leaders Meeting

19:00 – 21:00 Dinner (\*\*)

### 22th August, Monday

06:30 – 07:30 Breakfast (\*)

07:30 – 8:00 Departure to the Long Distance Qualification event  
(at least one hour by car from the event center)

08:30 – 15:00 Opening hours of the Event Office in Chiuppano

8:30 - 10:15 entry in quarantine zone Chiuppano

09:30 – 14:00 Long Distance Qualification – Zugliano-Chiuppano

12:00 – 15:00 Lunch possibility at the arrival Arena (Piazza dei Terzi)

14:00 – 15:00 Open Event – Shorted Long Distance

17:45 – 18:30 Team Leaders Meeting Vicenza

18:30 – 19:30 Opening ceremony Vicenza

20:00-21:30 – Dinner (\*\*)



**più valore  
al nostro territorio**



**23th August, Tuesday**

06:30 – 07:30 Breakfast (\*)  
07:30 – 8:00 Departure to the Long Distance Final event  
(60 - 75min by car from the event center)  
8:30 - 10:30 entry in quarantine zone Marostica  
08:30 – 12:30 Opening hours of the Event Office Marostica Sportsground  
09:30 – 14:30 Long Distance Final Marostica– Bassano  
13:30 – 16:00 Long Distance Final B Marostica– Bassano  
14:30 – Flower ceremony Piazza Libertà – Bassano  
15:30 – 17:00 Opening hours of the Event Office in Bassano  
17:00 – 17:30 Long Distance Prize giving ceremony Bassano  
19:30 – 21:00 Dinner (\*\*)  
21:30 – “Welcome Party team leaders” in Hotel Castelli (team leaders meeting room)  
21:00 – 22:00 Opening hours of the Event Office of the Event Office Hotel Castelli, Montecchio M.

## 24th August, Wednesday

08:00 – 10:00 Breakfast (\*)  
09:00 – 10:00 Opening hours of the Event Office Hotel Castelli, Montecchio M.  
10:00 – 13:00 Tourist tour  
12:30 – 14:30 Lunch (\*\*)  
14:00 – 17:00 Tourist tour  
18:00 – 19:00 Opening hours of the Event Office Hotel Castelli, Montecchio M.  
19:00 – 19:45 Team Leaders Meeting  
19:00 – 21:00 Dinner (\*\*)

## 25th August, Thursday

07:00 – 08:00 Breakfast (\*)  
08:00 – 9:00 Departure to the Middle Distance Final Event – Pozzolo di Villaga  
(45 minutes by car from the event center)  
09:00 – 15:00 Opening hours of the Event Office in Pozzolo di Villaga  
08:30 - 09:45 entry in quarantine zone in Pozzolo di Villaga  
10:00 – 15:00 Middle Distance Final – Pozzolo di Villaga  
13:00 – End of quarantine zone  
14:00 – Flower ceremony in Pozzolo di Villaga  
12:00 – 15:30 Lunch possibility  
14:00 – 15:00 Open Event – Pozzolo di Villaga-Barbarano  
16:00 – Middle Final Prize giving ceremony  
19:00 – 19:45 Team Leaders Meeting  
19:00 – 21:00 Dinner (\*)  
18:00 – 19:00 opening hours Event Office Hotel Castelli, Montecchio Maggiore



Comitato Organizzatore MTBO 2011 - A.S.D. "SPHERA"  
Via L. Ariosto, 3 - 35010 Cadoneghe (PD)  
CF 92152920283 P. Iva 03946570284

event director: Gabriele Viale - cell. +39 338 6138508  
email: [director@mtbo2011.org](mailto:director@mtbo2011.org)

segreteria: tel. +39 049 706232 - fax +39 049 8887479  
cell. +39 346 6467774  
email: [segreteria@mtbo2011.org](mailto:segreteria@mtbo2011.org)

**www.mtbo2011.org**



**più valore  
al nostro territorio**





**più valore  
al nostro territorio**

## Logistic Information

### Accommodation

The organization allocated the teams to the available accommodation according to the conditions and requests.

Final distribution is (last update 14 July 2011):

COUNTRY	PEOPLE	ACCOMMODATION	BREAKFAST	LUNCH
Australia	9	13-20.08: Casa Trasparente, 71 via Cazzale, 36057 Arcugnano 0444550091; 20-28.08 appartamenti Castelli	own	
Austria E	12	apartment Castelli + 1 roulotte	Hotel Castelli	
Austria J	16	Hotel Castelli	Hotel Castelli	
Austria O	3	Fattoria Grimana via Zocco 101, 36047 Montegalda Vicenza	Own	
Belgium	5	Roulotte	Own	
China	5	Gym* + Hotel Castelli	Hotel Castelli	
Croatia	4	Bed and Breakfast La Colombara, via Colombara,5 36057 Pianezze di Arcugnano	Own	
Czech rep. E	12	Hotel Castelli	Hotel Castelli	
Czech rep. J	9	Hotel Castelli	Hotel Castelli	
Estonia	4	Affittacamere Cavallino Bianco, 14, via Mascagni Montecchio Maggiore 3395222889	Cavallino Bianco	Roxy BAR
Finland	22	Hotel Castelli	Hotel Castelli	
France	10	private apartment Arcugnano	Own	
Italy E	13	Hotel Castelli	Hotel Castelli	
Italy J	9	Hotel Castelli	Hotel Castelli	
Israel	2	apartment Castelli	Hotel Castelli	
Japan	9	Hotel Castelli	Hotel Castelli	
Lithuania	10	private apartment Arcugnano	Own	
Portugal	4	Apartment Castelli + Hotel Castelli	Hotel Castelli	
Romania	1	Hotel Castelli	Hotel Castelli	
Russia	36	Hotel Castelli	Hotel Castelli	
Slovakia	13	FATTORIA VILLA CURTI, Via Guglielmo Marconi, 16, 36050 Sovizzo Vicenza	Own	
Spain O	2	Camping	Own	
Switzerland O	1	gym	Own	
Switzerland E,O	13	Apartment Castelli + Hotel Castelli	Hotel Castelli	

**gym\*** = Palestra Scuole Elementari, via San Francesco, Montecchio Maggiore (VI)

**Hotel Castelli** = Hotel Castelli, viale Trieste, 89 Montecchio Maggiore (VI)





**più valore  
al nostro territorio**



The organization provides lunch at the arrival arena of Qualification race ( Chiuppano), Middel race ( Villaga), Relay race ( Alonte) at a cost of 5,00€ ( pasta + bread + 1 fruit + 0,5L bottle water) to be paid at the arena. In Bassano (Long Distance race on 23<sup>rd</sup> August), as the arrival is in the historical centre, there are many possibilities of lunch in Restaurants, Pizzerias, bars.

For organizing reasons, it would be appreciated if you book this kind of lunch possibility a day in advance.

Breakfast is normally at the accommodation in EC Hotel Castelli, except for teams accommodated in other structures:

Austria Open, Belgium, Bulgaria, Croatia, Estonia, France Elite and Junior, Denmark, France (Mr. Bernard Oudin), Germany, Great Britain, Hungary, Latvia, Lithuania, New Zealand, Slovakia, Spain (Jose Samper/ Jose Antonio Garcia Paredes), Sweden, Switzerland (Mr. Gaven), Ukraine

Teams China and Switzerland (Mr. Gaven) will have breakfast at the EC Hotel Castelli.

## Transportation

The use of private cars is allowed.

The organization can also transport teams when requested ( only if booked within 19<sup>th</sup> August)

We have the following formal requests (last update 14July2011):

From Venice airport to Event Center (€50,00 / per person and bike):

- Japan – x 5 people
- Japan – x 2 people

From Bergamo airport to Event Center (€90,00 / per person and bike):

- Finland - x 16 people

From Malpensa airport to Event Center (€120,00 / per person and bike):

- Portugal – x 4 people

From Vicenza Train Station (price per person and bike to be determined)

- China – x 2 people

Transport from event center to all competitions (€30,00 / per person and bike):

- Finland – x 16 people
- Estonia – x 5 people
- Switzerland – x 1 people
- Portugal – 4 people
- Denmark – x 15 people
- Japan – 7 people



Comitato Organizzatore MTBO 2011 - A.S.D. "SPHERA"  
Via L. Ariosto, 3 - 35010 Cadoneghe (PD)  
CF 92152920283 P. Iva 03946570284

event director: Gabriele Viale - cell. +39 338 6138508  
email: [director@mtbo2011.org](mailto:director@mtbo2011.org)

segreteria: tel. +39 049 706232 - fax +39 049 8887479  
cell. +39 346 6467774  
email: [segreteria@mtbo2011.org](mailto:segreteria@mtbo2011.org)

**www.mtbo2011.org**



**più valore  
al nostro territorio**

## WI-FI

Wi-Fi will be available at the arrival of every stage.

## WMTBOC 2011 AUGUST TRAINING CAMP

The WMTBOC 2011 Organizing Committee is offering a training camp from August 6 to 15, 2011 just prior to the event for all athletes that intend to take part in the 2011 World MTB-Orienteering Championships in Italy. During this training camp, the bikers will only find controls out in the forest but there will not be any time-keeping.

### Location:

The Official WMTBOC-2011 Training Camp will take place in Brendola, Asolo and Mussolente in the Provinces of Vicenza and Treviso.

### Maps:

Brendola Scale: 1:15000 5 mt Contours 12 km<sup>2</sup>

Asolo Scale: 1:15000 5 mt Contours 15 km<sup>2</sup>

Mussolente – Piana di Oriente Scale: 1:15000 5 mt Contours 18 km<sup>2</sup>

### Programme:

3 training maps with controls on the terrain from August 6 to 15, 2011

Brendola – only controls on the terrain

Asolo – only controls on the terrain

Mussolente – only controls on the terrain

### Price of the Training Camp: map package: 30 euro/per person

The map packages can be obtained if requested before from the front desk of Hotel Castelli in Montecchio Maggiore

**(Event Centre for the WMTBOC 2011)** from August 5, 2011. Each envelop contains a full set of 3 maps and the driving directions to the training areas.

We can only guarantee maps packages if required 5 days in advance.

### Distance to Training Camps

From Montecchio to Brendola (training map): 7 km

From Montecchio to Asolo (training map): 70 km

From Montecchio to Mussolente (training map): 67 km



**più valore  
al nostro territorio**



With reference to the art. 14.3 of the Competition Rules For International Orienteering Federation, the competition terrain for the World MTBO Championships (WOC-JWOC) Event is embargoed for the time period from 20.12.2009 to 01.09.2011.

The embargoed area is constantly under control by mapmakers and course setters.

It is possible to train in the embargoed areas only during official training camps and the O- bikers can use only maps obtained from the organizers. It must be clear that during training camp, o-bikers have to follow the rules of the Italian road code, maintain the right side on the road/path and the priority must be given to traffic coming from right side (bikes, cars, tractors, etc).

The roads and paths are not closed to traffic in the training area. Road crossings are unattended, so stop and check before you cross the roads/paths.

For any information or for Hotel reservations, please contact the WMTBOC-2011 Event Director, Gabriele Viale e-mail: [director@mtbo2011.org](mailto:director@mtbo2011.org) or mobile telephone number: +39 338 6138508.



Comitato Organizzatore MTBO 2011 - A.S.D. "SPHERA"  
Via L. Ariosto, 3 - 35010 Cadoneghe (PD)  
CF 92152920283 P. Iva 03946570284

event director: Gabriele Viale - cell. +39 338 6138508  
email: [director@mtbo2011.org](mailto:director@mtbo2011.org)

segreteria: tel. +39 049 706232 - fax +39 049 8887479  
cell. +39 346 6467774  
email: [segreteria@mtbo2011.org](mailto:segreteria@mtbo2011.org)

[www.mtbo2011.org](http://www.mtbo2011.org)



**più valore  
al nostro territorio**

## Technical Information World Mountain Bike Orienteering Championship 2011

### Long Distance Qualification

Map Scale 1: 15000

Contour Interval 5 m

Course Planner: Giuseppe Simoni

Terrain Description: Very Hilly with Forest and open areas, including urban areas.

Many forest tracks and paths of medium to fast going ride-ability. Both technical and physical skills will be fully tested.

Classes	Linear Course length (km)	Optimal Course length (km)	Optimal Climbing (m)	Control Points	Estimated Winner Time	Refreshments
WOC WOMEN	<b>10,150</b>	<b>18,500</b>	<b>570</b>	<b>16</b>	<b>55-60</b>	<b>1</b>
WOC MEN	<b>13,900</b>	<b>26500</b>	<b>750</b>	<b>14</b>	<b>72-78</b>	<b>1</b>
JWOC WOMEN	<b>8,000</b>	<b>14500</b>	<b>470</b>	<b>14</b>	<b>50-55</b>	<b>0</b>
JWOC MEN	<b>9,400</b>	<b>17300</b>	<b>510</b>	<b>14</b>	<b>50-55</b>	<b>0</b>

### Long Distance Final

Map Scale 1: 15000

Contour Interval 5 m

Course Planner: Roberto Manea

Terrain Description: Very Hilly with Forest and open areas, including urban areas.

Many forest tracks and paths of medium to fast going ride-ability. Both technical and physical skills will be fully tested.

Classes	Linear Course length (km)	Optimal Course length (km)	Optimal Climbing (m)	Control Points	Estimated Winner Time	Refreshments
WOC WOMEN	<b>19.100</b>	<b>27.500</b>	<b>750</b>	<b>22</b>	<b>87-92</b>	<b>2</b>
WOC MEN	<b>24.790</b>	<b>37.300</b>	<b>1.350</b>	<b>27</b>	<b>107-115</b>	<b>2</b>
JWOC WOMEN	<b>16.060</b>	<b>22.750</b>	<b>550</b>	<b>20</b>	<b>70-75</b>	<b>1</b>
JWOC MEN	<b>20.790</b>	<b>28.000</b>	<b>750</b>	<b>23</b>	<b>85-90</b>	<b>1</b>
WOC MEN B	<b>16.450</b>	<b>23.300</b>	<b>600</b>	<b>23</b>	<b>65-70</b>	

### Middle Distance Final

Map Scale 1: 15000

Contour Interval 5 m

Course Planner: Andrea Cipriani

Terrain Description: Hilly. Forest and open areas. Well defined tracks and paths with medium to fast going ride-ability.

Demanding technical skills. Slow ride-ability in case of rain.

Classes	Linear Course length (km)	Optimal Course length (km)	Optimal Climbing (m)	Control Points	Estimated Winner Time	Refreshments
WOC WOMEN	<b>9,300</b>	<b>15,000</b>	<b>360</b>	<b>16</b>	<b>45-50</b>	<b>1</b>
WOC MEN	<b>13,000</b>	<b>19,000</b>	<b>430</b>	<b>18</b>	<b>55-58</b>	<b>1</b>
JWOC WOMEN	<b>7,200</b>	<b>11,500</b>	<b>300</b>	<b>14</b>	<b>38-40</b>	<b>1</b>
JWOC MEN	<b>9,600</b>	<b>15,500</b>	<b>380</b>	<b>16</b>	<b>45-50</b>	<b>1</b>









**più valore  
al nostro territorio**

### Punching System

The SPORTident system will be used for all events. Competitors can use their own SI Card or the Organizers can provide a rental SI Card upon request.

### Anti Doping

Doping control will be done throughout the competition.

The organizers are committed to do everything required to assist the official anti-doping authorities at the MTB

WOC 2011 to successfully and transparently carry out their work. We strongly support all positive efforts to keep our sport clean and doping-free.

This event applies IOF Anti-Doping Rules, valid from 1 February 2010. Please consult

<http://orienteering.org/wp-content/uploads/2010/12/IOF-A-D-Rules-2010.pdf>

### Weather

During August you can expect temperatures from 20° to 35° Celsius during the day and from 10° to 20° at night.

It's possible to have very hot temperatures during the competition days. Please take extra care to avoid dehydration. It's advisable to bring a strong sunscreen with you.

### Health Care

The Organization will provide first aid at each competition site.

The Organization will not bear costs connected to health insurance of participants. It is recommend that all participants have their own personal health insurance. Participants take part at their own risk.

The nearest hospital from the event centre is in Montecchio Maggiore, 2 km from the Event Centre, otherwise there is one in Vicenza, 17 km from Event Center.

**più valore  
al nostro territorio**

## Entries

		JWOC					WOC					OPEN		TOTAL		
		M	W	OFFICIALS	RELAY MEN	RELAY WOMAN	M	W	OFFICIALS	RELAY MEN	RELAY WOMAN	M	W	ATHLETES	OFFICIALS	TOTAL
1	Australia	4			1		2	1	2	1			1	8	2	10
2	Austria	6	3	2	2	1	6	3	2	2	1	7	1	26	4	30
3	Belgium						1							1	0	1
4	Bulgaria						1		1					1	1	2
5	China						1		4			1		2	4	6
6	Croatia						4	1		1				5	0	5
7	Czech Rep.	4	4	1	1	1	6	4	2	2	1	2		20	3	23
8	Denmark	3	3	1	1	1	4	4		1	1	1		15	1	16
9	Estonia	1					2			1				3	0	3
10	Finland	6	3	1	2	1	6	4	2	2	1	1		20	3	23
11	France	3		1	1		4	2	1	1		1		10	2	12
12	Germany	4	2		1		1							7	0	7
13	Great britain	1					1	3			1			5	0	5
14	Hungary	4	1		1		2	2			1			9	0	9
15	Israel						2							2	0	2
16	Italy	6	3		2	1	6	3	4	2	1			18	4	22
17	Japan						6	3		2	1			9	0	9
18	Latvia	4			1									4	0	4
19	Lithuania	3			1		3	3		1	1			9	0	9
20	New zealand		1									1		2	0	2
21	Portugal						3		1	1				3	1	4
22	Romania											1		1	0	1
23	Slovakia	3		1	1		3	3	1	1	1	2		11	2	13
24	Spain	1					4	3		1	1	1	1	10	0	10
25	Sweden	5		1	1		3		1					8	2	10
26	Switzerland						6	5	1	2	1	1		12	1	13
27	Ukraine							1						1	0	1
total pax		58	20	8	16	5	77	45	22	21	12	19	3	222	30	252

(last update 14 July 2011)

**Embargoed areas: same as bulletin 2. Links:**

[http://dl.dropbox.com/u/4773367/w-mtboc\\_2011/wmtbo2011/ZONA%20EMBARGO%201x.pdf](http://dl.dropbox.com/u/4773367/w-mtboc_2011/wmtbo2011/ZONA%20EMBARGO%201x.pdf)

[http://dl.dropbox.com/u/4773367/w-mtboc\\_2011/wmtbo2011/ZONA%20EMBARGO%202ax.pdf](http://dl.dropbox.com/u/4773367/w-mtboc_2011/wmtbo2011/ZONA%20EMBARGO%202ax.pdf)